

SPECIFICATIONS

ELECTRICAL

RESISTANCE RANGE ----- SEE CHART
 RESISTANCE TOLERANCE ----- ±3%
 LINEARITY TOLERANCE ----- ±0.25%
 RESOLUTION ----- SEE CHART
 END RESISTANCE AT TERM. ----- 1 OHM OR 0.1%
 ELECTRICAL ANGLE ----- 3600°±5°
 ELECTRICAL NOISE ----- 100 OHM MAX.
 POWER RATING ----- 1.5 WATTS
 MAXIMUM VOLTAGE ----- 450 VOLTS
 INSULATION RESISTANCE ----- 1,000 MEGOHMS @ 500 V.D.C.
 DIELECTRIC STRENGTH ----- 1,000 V.A.C.

MECHANICAL

NUMBER OF TURNS ----- 10
 MECHANICAL ANGLE ----- 3600°+15°-0°
 TORQUE ----- 0.4 OZ. IN. MAX.
 STOP STRENGTH ----- 20 OZ. IN. MAX.
 WEIGHT ----- 0.35 OZ.

ENVIRONMENTAL

OPERATING TEMPERATURE ----- -55°c to +105°c
 TEMPERATURE COEFFICIENT ----- SEE CHART
 VIBRATION ----- 10Hz TO 2000Hz 15G
 SHOCK ----- 50G 11mS
 MOISTURE RESISTANCE ----- 40°c 95%RH 120 HOURS
 ROTATIONAL LIFE ----- 1,000,000 SHAFT REVOLUTIONS

MATERIALS

HOUSING ----- HIGH TEMPERATURE PLASTIC
 SHAFT ----- STAINLESS STEEL
 BUSHING ----- BRASS
 TERMINALS ----- GOLD PLATED
 ELEMENT ----- WIREWOUND

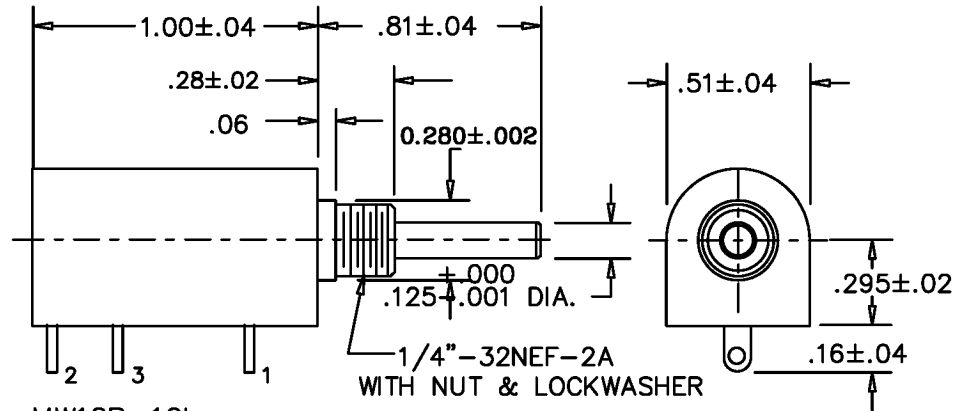

MW12B-10L

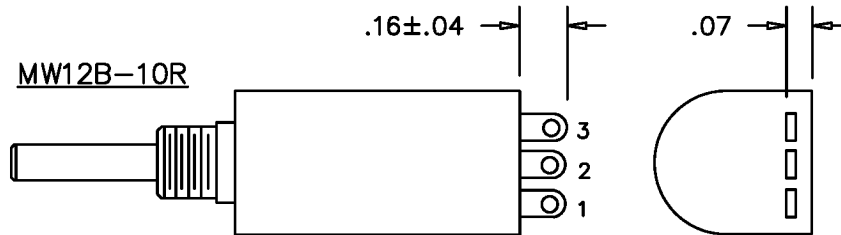

MW12B-10R

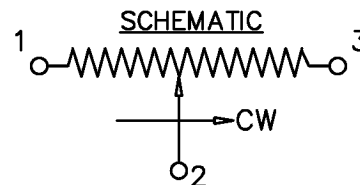

| | | | | | | | | | | | | |
|---------------------------------|------|------|------|------|------|------|------|------|------|------|------|------|
| RESISTANCE | 20 | 50 | 100 | 200 | 500 | 1K | 2K | 5K | 10K | 20K | 50K | 100K |
| RESOLUTION | .070 | .050 | .059 | .054 | .039 | .040 | .033 | .024 | .021 | .016 | .012 | .009 |
| TEMPERATURE COEFFICIENT, PPM/°C | 700 | 700 | 80 | 80 | 80 | 20 | 20 | 20 | 20 | 20 | 20 | 20 |